

OWNER'S MANUAL

W360 PTO PUMP AND RESERVOIR KIT FOR 7-1/2 and 8-1/2 FOOT BACKHOES FOR TRACTORS WITH 540 RPM PTO SHAFT OR 1000 RPM (1-3/8" - 6 tooth spline) PTO SHAFT

General Description

The W360 PTO Pump Kit consists of those parts required to power the 7-1/2 Foot or 8-1/2 Foot Backhoe from the tractor's PTO shaft. It includes the PTO pump and adapter, reservoir, filtration system, hydraulic hoses, and fittings. In addition it includes a pump torque arm which attaches to the tractor's lower link and keeps the pump from turning with the PTO shaft.

NOTE - The speed of backhoe operation increases as PTO speed increases. When using a 1000 RPM PTO, engine speed must be reduced to obtain acceptable backhoe operating speed.

Assembly

NOTE - When installing hoses and fittings always use thread sealant in permanent connections. Do not use thread sealant in union ends of adapters. Do not over-tighten fittings, they can split or expand causing leakage.

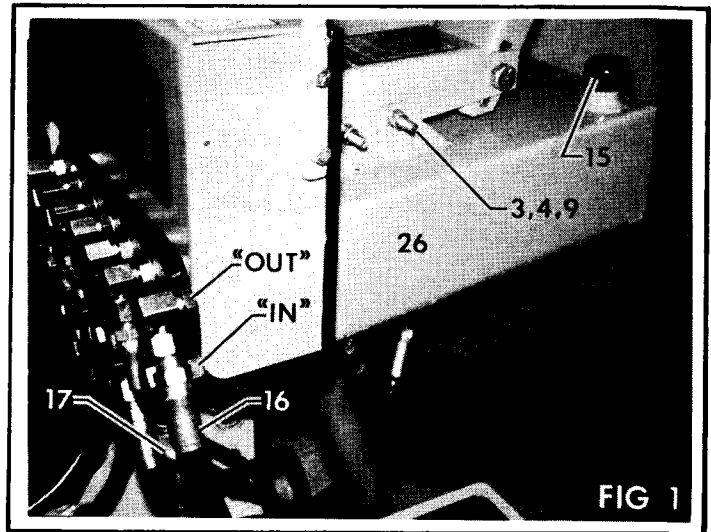

IMPORTANT - Tighten all hardware to the torque requirements specified in the Torque Chart, Page 3, of this manual.

1. Assemble reservoir (26) to backhoe using 3/8 NC x 6" bolts, nuts, and lock-washers (3,4,9) as shown in Fig 1.

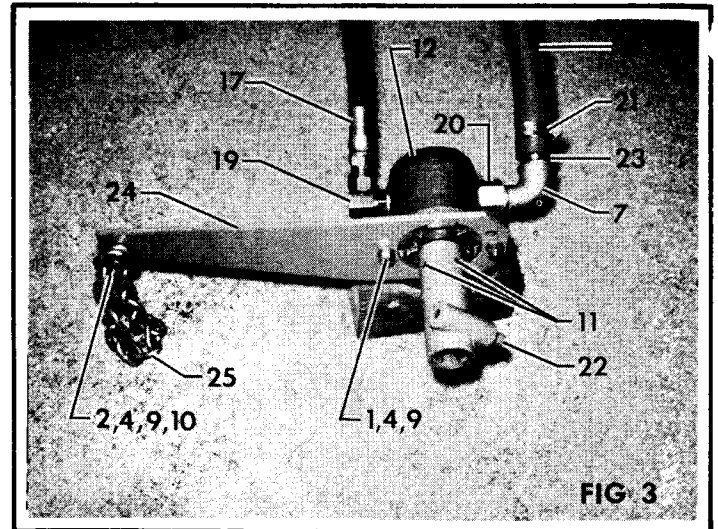
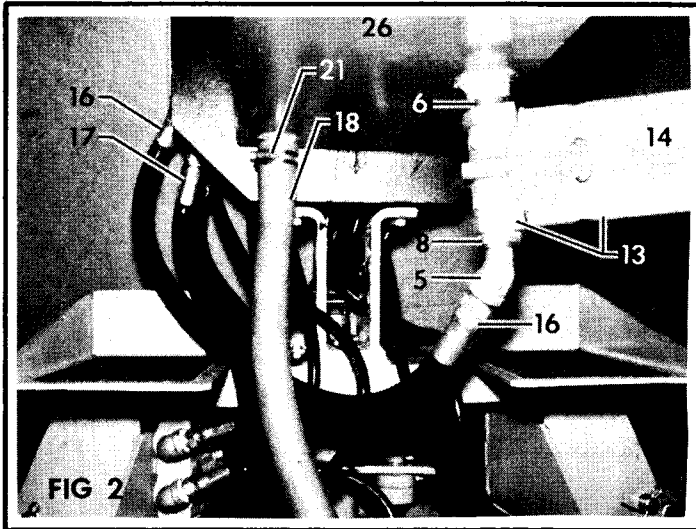

2. Assemble suction hose (18) to reservoir (26) using hose clamp (21), as shown in Fig 2.

3. Assemble filter base and element (13) to reservoir (26), using close nipple (6), as shown in Fig 2.

NOTE - Change filter element (14) every time oil is changed.

4. Assemble pump plate (24) to pump (12), using hardware provided (1,4,9), as shown in Fig 3. Pump plate may have to be re-adjusted later.

5. Slide PTO adapter (22) onto pump shaft allowing 1/8 inch between adapter and pump face and secure with two setscrews (11), as shown in Fig 3.

6. Assemble suction hose (18) to pump (12) using pipe adapter (20), street elbow (7), hose nipple (23), and hose clamp (21), as shown in Fig 3.

7. Connect pressure line between valve "in" port fitting and pump using adapter union (19), and hose (17), as shown in Fig 1 and 3.

8. Assemble return line (16) between filter base (13) and valve "out" port fitting, using street elbow (5), and pipe bushing (8), as shown in Fig 1 and 2.

IMPORTANT - If hoses are hooked up incorrectly, serious damage to the backhoe valve will result.

9. Fill reservoir with recommended fluid to correct level, referring to Service Section in the Backhoe Manual. Attach breather filter (15) to top of reservoir.

10. Mount the backhoe to the tractor at this time following the procedure in the Attaching Kit Manual.

11. Slide complete pump assembly onto the PTO shaft and secure with lock pin on PTO adapter. Be sure kinks do not develop in any of the lines. Suction hose can be shortened to prevent this problem.

⚠ CAUTION - Do not remove the tractor PTO guard.

12. Attach pump plate (24) to tractor's lower link using hook-up chain (25), and hardware (2,4,9,10) provided, as shown in Fig 3. Pump plate (24) may be adjusted on pump (12) for proper fit-up to lower link if necessary.

IMPORTANT - When mounting backhoe on the adapter, do not let the swing cylinders interfere with the backhoe pump, or the hydraulic lines become tangled in any part of the adapter during installation.



Parts List

Index	Description	Part No.	Index	Description	Part No.
1	Bolt, 3/8 NC x 1-1/4.....	6857	15	Breather.....	10385
2	Bolt, 3/8 NC x 2".....	6872	16	Hydraulic Hose, 1/2 NPT x 1/2 NPT x 29".....	10979
3	Bolt, 3/8 NC x 6".....	6907	17	Hydraulic Hose, 1/2 NPT x 1/2 NPT x 38".....	10986
4	Nut, 3/8 NC.....	7451	18	Suction Hose, 1" ID x 36"...	11026
5	Street Elbow, 1/2 NPT x 45°..	7918	19	Adapter Union, 7/8-14 M x 1/2 NPT x 90°.....	11142
6	Close Nipple, 3/4 NPT.....	7948	20	Pipe Adapter, 1-3/16-12 M x 3/4 NPT.....	11237
7	Street Elbow, 3/4 NPT x 90°..	7975	21	Hose Clamp.....	14150
8	Pipe Bushing, 3/4 NPT M x 1/2 NPT F.....	7987	22	PTO Adapter.....	15046
9	Lockwasher, 3/8.....	8079	23	Hose Nipple.....	780833
10	Flat Washer, 3/8.....	8156	24	Pump Plate.....	850697
11	Setscrew, 5/16 NC x 3/8 cup point.....	8321	25	Hook-up Chain.....	851834
12	Hydraulic Pump (see page 4 for breakdown)..	10173	26	Reservoir.....	856565
13	Filter Base and Element.....	10375			
14	Filter Element Only.....	10376			

TORQUE VALUES

Common bolts and nuts.

Tightening Torque \pm 20%

SIZE	GRADE 2 	GRADE 5 	GRADE 8 
1/4-20 NC	70 in lb	115 in lb	165 in lb
1/4-28 NF	85 in lb	140 in lb	200 in lb
5/16-18 NC	150 in lb	250 in lb	350 in lb
5/16-24 NF	165 in lb	270 in lb	30 ft lb
3/8-16 NC	260 in lb	35 ft lb	50 ft lb
3/8-24 NF	300 in lb	40 ft lb	60 ft lb
7/16-14 NC	35 ft lb	55 ft lb	80 ft lb
7/16-20 NF	45 ft lb	75 ft lb	105 ft lb
1/2-13 NC	50 ft lb	80 ft lb	115 ft lb
1/2-20 NF	70 ft lb	105 ft lb	165 ft lb
9/16-12 NC	75 ft lb	125 ft lb	175 ft lb
9/16-18 NF	100 ft lb	165 ft lb	230 ft lb
5/8-11 NC	110 ft lb	180 ft lb	260 ft lb
5/8-18 NF	140 ft lb	230 ft lb	330 ft lb
3/4-10 NC	150 ft lb	245 ft lb	350 ft lb
3/4-16 NF	200 ft lb	325 ft lb	470 ft lb

NOTE - See tractor instruction manual or your tractor dealer for tightening of metric bolts.

Webster Pump No. 10173

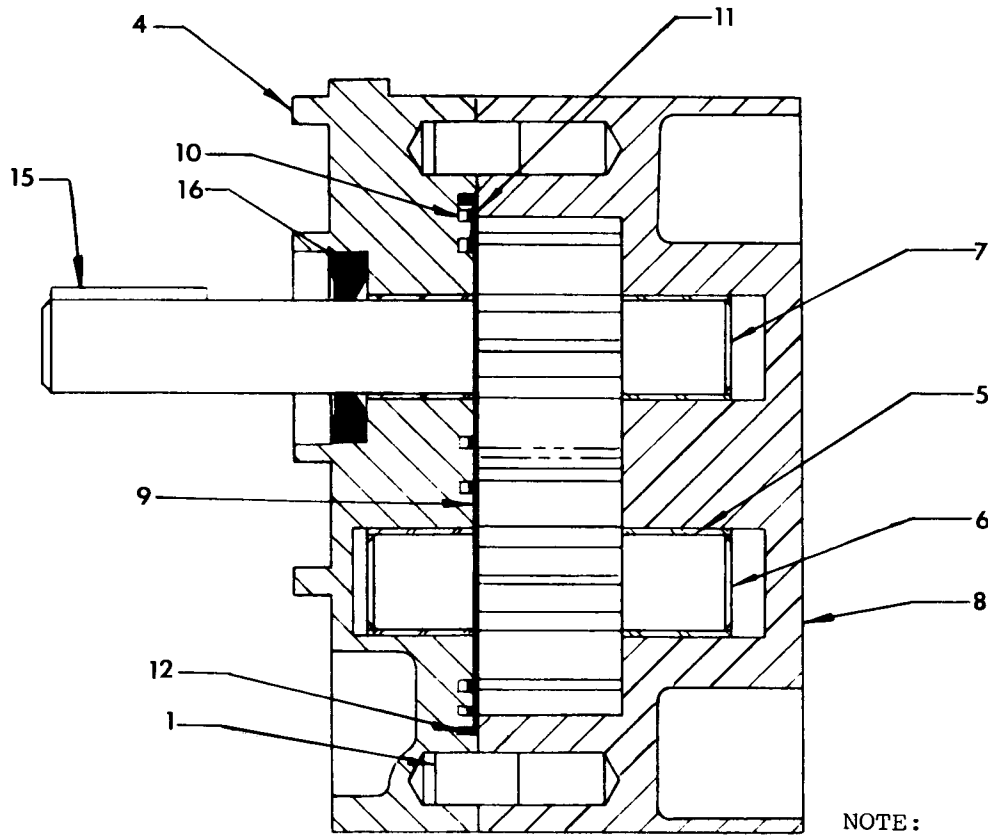

NOTE:

Bolt #2 - torque to 360-380 in lb
 Bolt #3 - torque to 190-210 in lb

Parts List

Index	Part No.	Description	Quantity Per Pump
1	*	Dowel Pin.....	2
2	*	Socket Head Screw, 3/8-16 x 1-1/2.....	4
3	*	Socket Head Screw, 5/16-18 x 1-1/4.....	4
4	*	Body Assembly, with Bearings and Seal.....	1
5	*	Bearing.....	4
6	*	Idler Shaft/Gear Assembly.....	1
7	*	Drive Shaft/Gear Assembly.....	1
8	*	Cover Assembly, with Bearings.....	1
9	**	Wear Plate.....	1
10	**	Pre-Load Seal (Rubber).....	1
11	**	Load Seal.....	1
12	**	Sealing Ring.....	1
13	**	Washer, 3/8.....	4
14	**	Washer, 5/16.....	4
15	**	Key.....	1
16	10191	Seal and Retaining Ring.....	1
	10192	Pump Seal Kit, consisting of: #9 Wear Plate (1), #10 Pre-Load Seal (1), #11 Load Seal (1), #12 Sealing Ring (1), #13 Washers (4), #14 Washers (4), #15 Key (1), and #16 Seal and Retaining Ring (1).....	1

* Not available as a separate repair part.

** Not available as a separate repair part, order Pump Seal Kit.